



ISO-DOR™

INSULATED STEEL DOORS



Rugged 24, 20, and 16 gauge insulated and laminated steel doors provide superior strength and energy efficiency

FIMBEL - Quality Since 1924

ISO-DOR™ INSULATED STEEL DOORS

SPECIFICATIONS & FEATURES

DOOR SECTIONS - SI-2424A - Continuous 24 ga. embossed steel exterior and 24 ga. aluminum magnesium alloy interior (other ISO-DOR skin options are available). Both skins are laminated to a continuous VPS foam plastic core to form a rigid sandwich panel 2- 1/8" thick with an R-value not less than 13.62 and a windload rating of 30 P.S.F.

FINISH - Exterior steel skins are hot-dipped galvanized, bonderized and prepainted with a two coat polyester finish of white or Doric brown. Interior skins are white. Custom powder coat finishes are optional.

WEATHERSTRIP - Weatherstrip package consists of an EPDM flexible head seal and heavy duty bottom astragal. Jamb seals are optional.

HARDWARE - All door hardware is heavy duty and galvanized. Rollers are 10 ball bearing 2" for 2" track (3" for 3" track).

TRACK - 2" track is a minimum of 14 gauge, and can be bracket mounted or optionally available with 4- 1/4" x 2- 1/2" continuous angle. Heavy duty 3" track is a minimum of 12 gauge and is mounted on 4- 1/2" x 3" continuous angle. Note: all tracks should be designed to clear the maximum height off the floor, consult factory for information.

COUNTERBALANCE - Oil-tempered helical wound torsion springs mounted on a steel shaft with a minimum of 10,000 cycles. Extra high cycle torsion springs are available. Extension springs are also available. Consult factory.

LOCK - Lock to be interior mounted slide lock (optional keyed cylinder lock available).

OPERATION - All doors are designed for manual push up operation, optional chain hoist or motorized operators are available. Consult factory for proper sizing on motor operators.

5 YEAR LIMITED WARRANTY

Against panel delamination of foam and metal skins. One year on workmanship and materials

8 CODDINGTON ROAD - PO BOX 96
WHITEHOUSE, NEW JERSEY 08888
PHONE: 908-534-1732 - FAX: 908-534-9259

WWW.FIMBELADS.COM

- MODEL SI-2424A - 24 ga. Steel exterior, 24 ga. Aluminum interior
- MODEL SI-2424 - 24 ga. Steel exterior, Steel interior
- MODEL SI-2024A - 20 ga. Steel exterior, 24 ga. Aluminum interior
- MODEL SI-2024 - 20 ga. Steel exterior, Steel interior
- MODEL SI-1624A - 16 ga. Steel exterior, 24 ga. Aluminum interior
- MODEL SI-1624 - 16 ga. Steel exterior, Steel interior

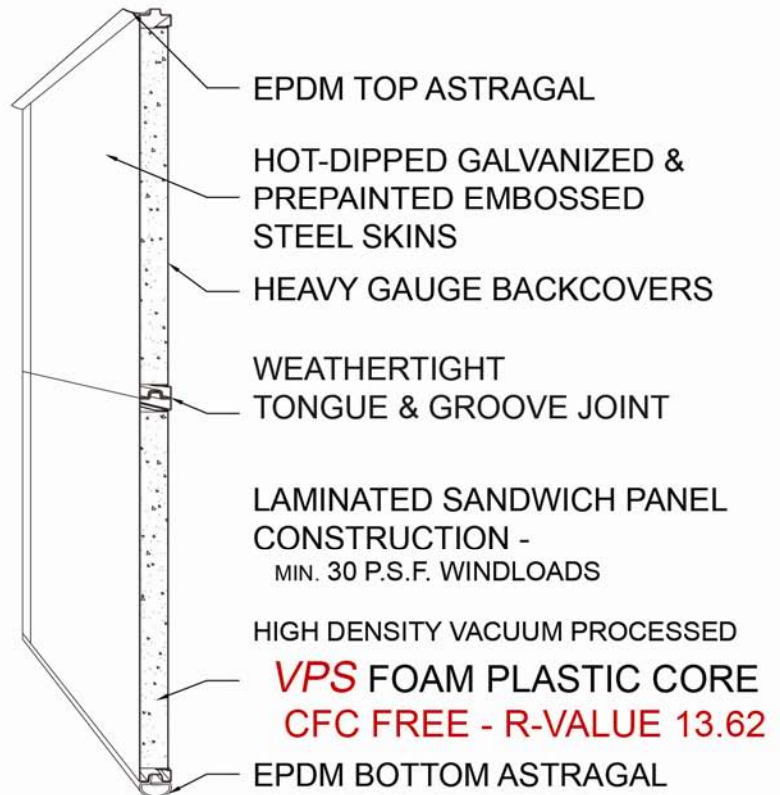

OPTIONS: -Thermal Glazing - Full View aluminum sections - High usage packages - Jamb weather-stripping - Chain hoists - Jackshaft & drawbar electric operators - Safety sensing edges - Pass Doors - Custom applications are our specialty

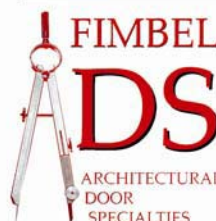

Distributed By:

Blank space for distributor information.