



# DELUXE ESTATES SERIES

## CARRIAGE HOUSE DOORS

"THE ORIGINAL SINCE 1924"



*Available in Stain Ready  
&  
Paint Grade Designs*

1. Insulated Core, R-Value 7.18
2. Stain-Grade Doors built with a plywood interior, Paint-Grade with Tempered Hardboard
3. Meranti-Mahogany Cope&Bead overlays on face for Stain-Grade Doors, Paint-Grade receives Cope&Bead Dur-A-Tek <sup>(TM)</sup> Hardwood Composite overlays
4. Heavy Duty Wood frame at all Hardware Fastening Points
5. Tempered Hardboard face for Paint-Grade doors, Meranti-Mahogany Ply for Stain-Grade

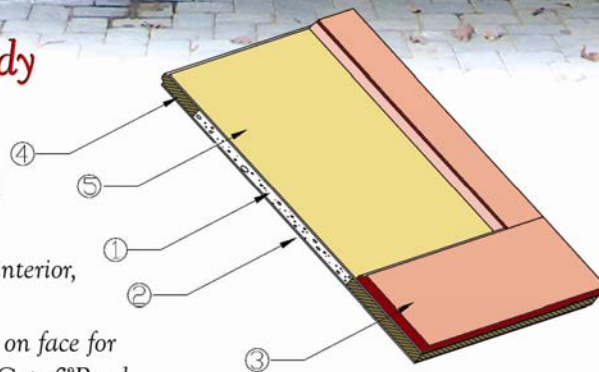

Fimbel Architectural Door Specialties  
PO Box 96  
Whitehouse, NJ 08888  
ph: 908-534-1732 fx: 908-534-9259

Visit Us on the Web:  
[www.fimbelads.com](http://www.fimbelads.com)



# DELUXE ESTATES SERIES

## CARRIAGE HOUSE DOORS

"THE ORIGINAL SINCE 1924"

Since 1924 the Fimbel family has been manufacturing custom wood doors. Eighty years experience and modern technology have allowed us to proudly offer the Deluxe Estates Series of Carriage House Doors. The Deluxe Estates Series is an affordable upgrade to our American Estates Series, available in paint or stain grades. Choose a standard design below, or tell us about that look you've been dreaming of. We will be happy to oblige!

### ...ENCHANTING

The Deluxe Estates Series is an insulated 1 3/4" thick door. Paint grade models are constructed of tempered hardboard cores with Dur-A-Tek (TM) Hardwood Composite overlays. Glass options are available with grilles or Tru-Divided lites. Stain grade models have clear Meranti-Mahogany cores with solid Meranti-Mahogany overlays. Stain grade models are available with Tru-Divided lites only. All overlays for the Deluxe Estates Series have a stylish cope & bead finished edge.



### ...CLASSIC

Deluxe Estates Series Doors are available in 8',9',10' and 16' wide by 6'6", 7'0" 7'6" and 8'0" high in the designs shown below. These standard designs and sizes offer quicker delivery at a reduced cost to you. Of course, should the need arise, Deluxe Estates Series Doors are also available in custom designs and sizes. Please consult the Factory for additional information.

### A SPLASH OF STYLE...

#### Standard Deluxe Estates Designs:

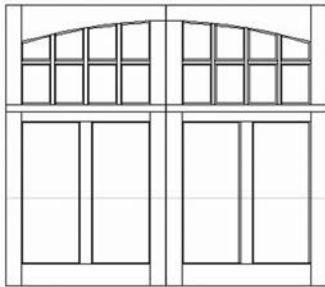

DE-227  
CARNEGIE

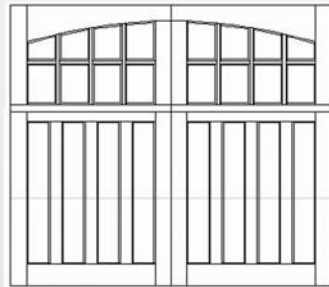

DE-247  
GRAYSON

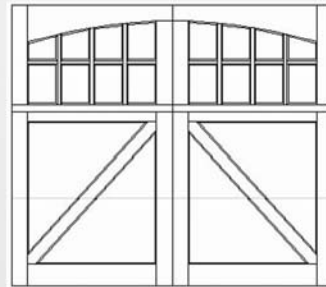

DE-257  
BALDWIN

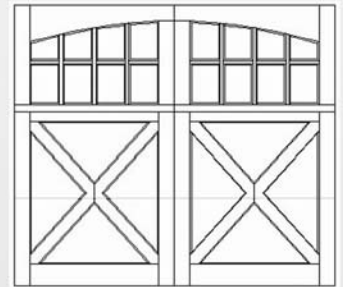

DE-277  
WENTWORTH

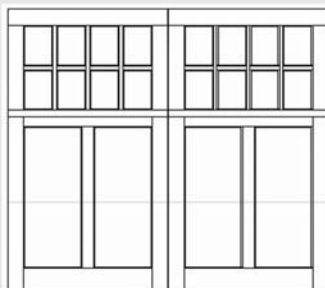

DE-228  
MORRIS

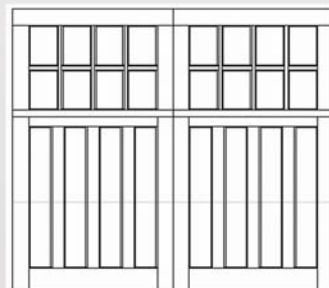

DE-248  
DOUGLAS

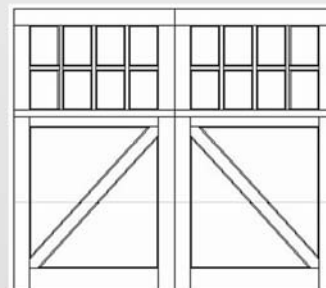

DE-258  
DRISCO

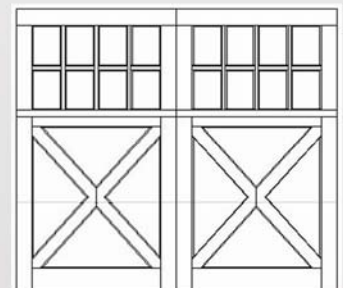

DE-278  
WHARTON